

Data outlet Carrier plate for Ackermann Underfloor systems GB2 and GB3

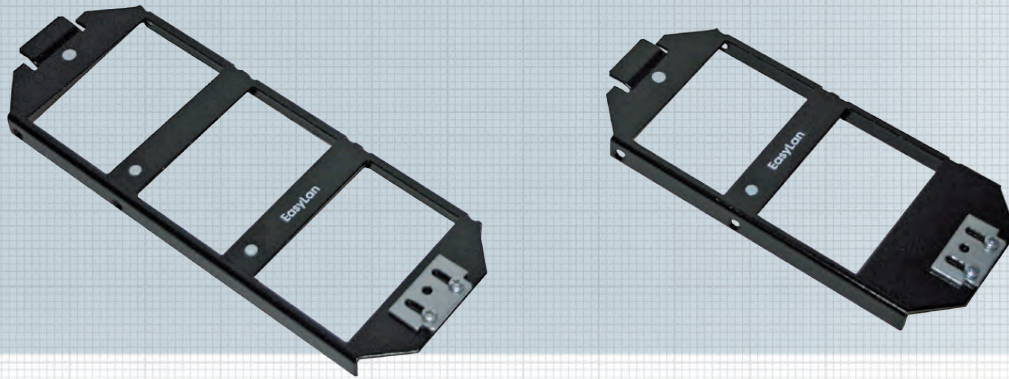

The support plate replaces the device frame, resulting in maximum space for cable feed. Diagonal infeed and outfeed enable secure cable guiding even in very low false floors.

This version is intended for direct assembly of data outlets, which can be secured directly to the supporting plate. To prevent entry by dust, unneeded space on the supporting plate can be covered with dummy plates.

Properties:

Dimensions	According to specifications for Ackermann Sub-floor systems
Material	Steel plate, Hot-dipped galvanized
Color	black, RAL 9005
Material thickness	1.5 mm
Mounting	with a max. of 3 data outlets
Version	GB2 and GB3
Packaging unit	10 pieces

Description	Ordering code
Ackermann Carrier plate GB2	ABG00001
Ackermann Carrier plate GB3	ABG00002
Dummy plate, black RAL 9005	ABG00003