

Designable Data outlets empty, 45° Snap-in angle, Single, Double

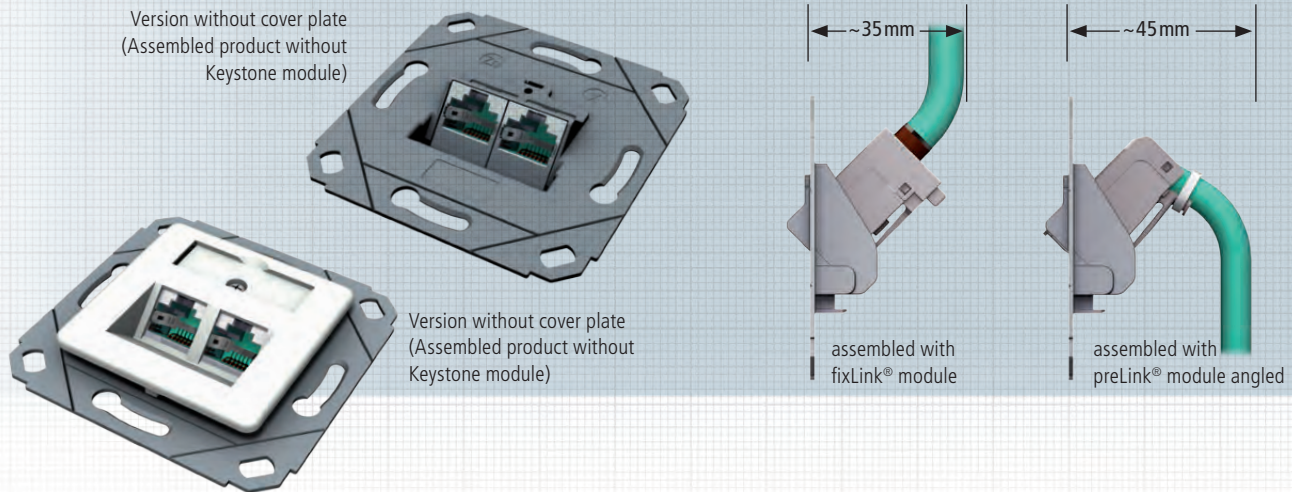

The multi-design capable data outlets consist of a die-cast zinc frame. They are suitable for installation in a cable channel (IC), for flush mounting (FM) or using a separate frame for surface mounting (SM). Removing the two mounting tabs also enables mounting as a floor device (FD). The multi-design capable data outlet is compatible with nearly all switch products available on the market.

Accessories:

Surface Mount Housing IP20 80 x 80 x 42 mm



Cover plates single/double



Carrier Sub-floor



| Description | Ordering Code |
|--|---------------|
| Designable Data outlets (without cover plate), single/double | CKVD1DS |
| Surface Mount Housing IP20 80 x 80 x 42 mm | ADZ00101 |
| Cover plate single, 80 x 80 mm | ADZ00102 |
| Cover plate double, 150 x 80 mm | ADZ00103 |

Properties:

| | |
|----------------------|---|
| Material | Module mount: Die-cast zinc |
| Color cover Plate | White, similar to RAL 9010 |
| Mounting | Central plate 50 x 50 mm, • preLink® angled • fixLink® |
| Range of application | Installation in cable duct, flush or surface mounting, can be combined with all VAE central plates from common switch manufacturers |
| Packaging unit | 5 pieces per box |

Properties Surface Mount Housing IP20, 80 x 80 x 42 mm:

| | |
|----------------------|--|
| Material | Plastic |
| Dimensions | 80 x 80 x 42 mm |
| Color | White, similar to RAL 9010 |
| Range of application | Surface-mount housing for multi-design module receptacle |
| Packaging unit | 5 pieces per box |

Properties Cover plates single/double:

| | |
|----------------------|--|
| Material | Plastic |
| Color | White, similar to RAL 9010 |
| Range of application | Cover plate for multi-design module receptacle |
| Packaging unit | 5 pieces per box |

Properties Carrier Sub-floor:

| | |
|--------------------|---|
| Dimension | According to specifications for Ackermann Sub-floor systems |
| Material | Steel plate, Varnished |
| Color | black, RAL 9005 |
| Material thickness | 1.5 mm |
| Mounting | with 2 or 3 Data outlets |
| Version | GB2 and GB3 |
| Packaging unit | 10 pieces |

| Description | Ordering Code |
|-----------------------------|---------------|
| Ackermann Carrier plate GB2 | ABG00101 |
| Ackermann Carrier plate GB3 | ABG00102 |
| Dummy plate black RAL 9005 | ABG00103 |